



4 🚗 2 🛏 2 🚗

Contact Les Kelly
0427 315 545

Type House

Sold Date 29/04/2019

Land 916 m2

Perfectly positioned in the sought after popular suburb of TATTON. Minutes to the country golf & boat clubs & the shores of Lake Albert.

This magnificent home offers an easy care lifestyle with effortless entertaining both inside & out. Built With luxury and quality in mind this home is sure to impress the home buyer that is seeking high standards and an ultra modern sleek home.

The open plan living area incorporates the kitchen, dining and living zone as well as an additional living area with built-in cabinetry.

The sophisticated modern kitchen with quality Smeg appliances, dual ovens and dishwasher, induction cook-top, breakfast bar, Essa Stone built-in table, eye catching mirrored splash back and practical butlers pantry will delight

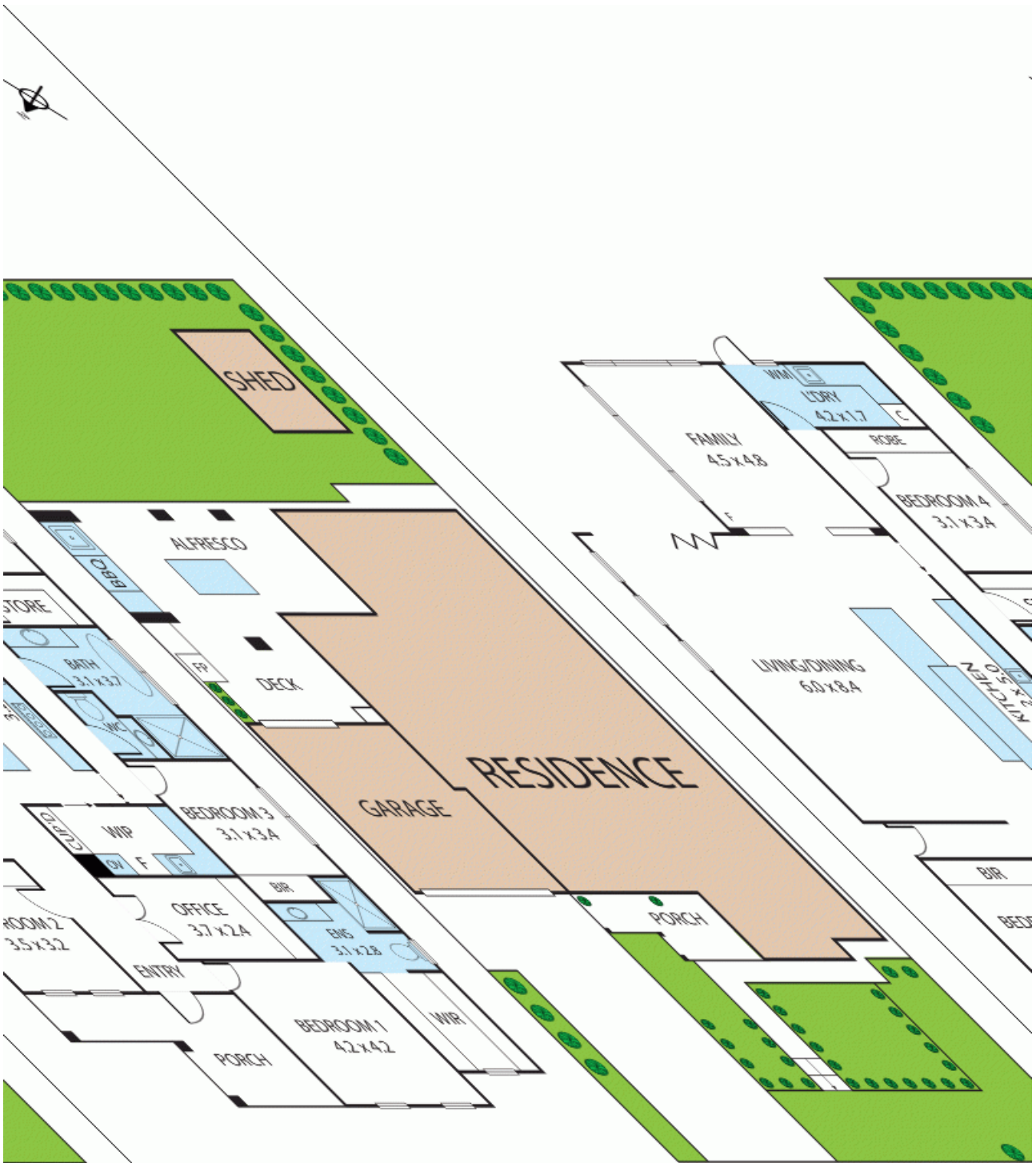

10 Clarence Place, Totton 7650
 TOTAL APPROX. FLOOR AREA 241.50sqm

*While every attempt has been made to ensure the accuracy of the floor plan contained here, measurements of floors, windows, rooms and any other items are approximate and no responsibility is taken for any error, omission or misstatement. This plan is for illustrative purposes only and should be used as a guide for any prospective purchaser.