



4  2  3 

Contact Jenna Pollard
0418421621

Type House

Sold Date 03/04/2019

Land 6000 m2

Immerse yourself in the private lifestyle escape of this sought after Springvale address...

Commanding exterior with a stunning interior on 6,000m2! You will enjoy the northern orientation of this home, assuring all your natural warmth into the living zones.

Living spaces are aplenty with a formal lounge on entry flowing through to dining and family living featuring LED downlights throughout. The residence is kept in complete comfort by reverse cycle heating and cooling.

Enjoy the seamless indoor / outdoor living experience with a massive outdoor area overlooking the space and privacy experienced on acreage. Established gardens surround this home with layered garden beds, stunning trees featured

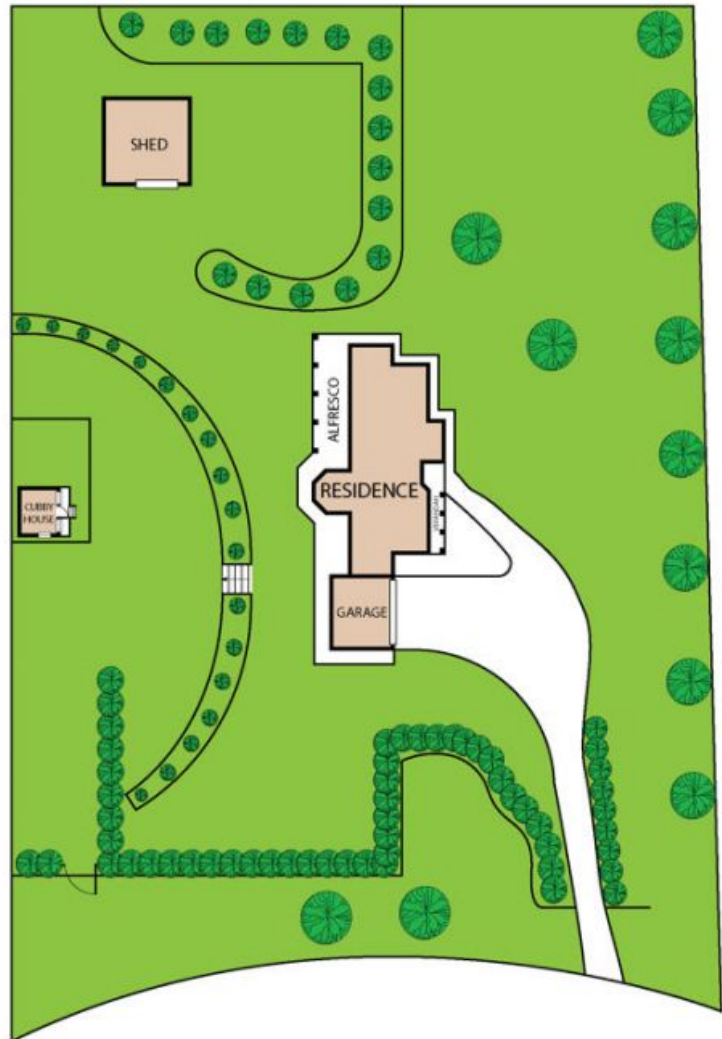

12 Casuarina Place, Springvale

TOTAL APPROX. FLOOR AREA 165 SQ.M

Whilst every attempt has been made to ensure the accuracy of the floor plan contained here, measurements of doors, windows, rooms and any other items are approximate and no responsibility is taken for any error, omission, or misstatement. This plan is for illustrative purposes only and should be used as such by any prospective purchaser.